

# AXENT.ONE

**SHOWER TOILET, FLOOR-STANDING** E80.0600.0001.9

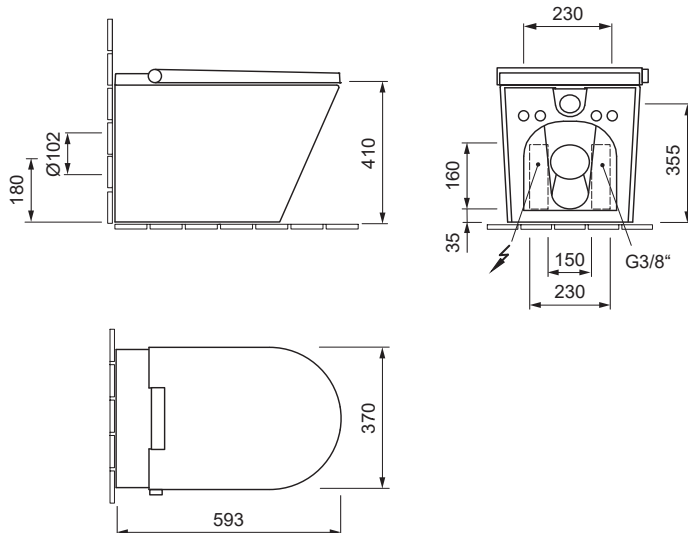

reddot award 2015  
winner



**DESIGN PLUS**  
powered by: **ISH**

## PRODUCT DETAILS

Dimensions / Weight	370 x 593 x 452 mm / 34,0 kg
Adaptable water pressure	0.7 – 7.5 bar
Water volume, shower function	0.35 – 0.85 l/min
Power consumption / Voltage	1600 W / 230V - 50Hz

## FEATURES

Rear wash	Night light
Lady wash	Soft-closing seat and lid
Adjustable water temperature	Rimless toilet
Adjustable flow rate	Decalcification
Adjustable spray arm position	Easy-clean ceramic surface

## SPECIFICATION TEXT

AXENT.ONE Floor-standing shower toilet complete solution, design by Matteo Thun & Partner. Washdown toilet made of sanitary ware with concealed fixation. Rimless toilet for 6 and 3 l flushing according to EN997. Basic functions: Rear and Lady shower; adjustable spray arm, water volume and temperature; self-cleaning; decalcification. Certified by LGA Würzburg. Rectangular basin shape, front merging into a semicircle. Dimension (wxdxh) 370x593x452 mm. White. Order no. E80.0600.0001.9

## AXENT International AG

info@axentbath.eu  
www.axentbath.eu

All drawings contain the necessary measurements which are subject to standard tolerances. They are stated in mm and are non-binding. Exact measurements, in particular for customised installation scenarios, can only be taken from the finished ceramic piece.